

Written approval for Deemed Permitted Boundary Activity

Pursuant to Section 87BA of the Resource Management Act 1991 (the Act).

1. Name of person giving written approval

2. I am the owner of the property at:

3. Address of the property subject to the proposal

4. Are you signing on behalf of other owners?

Yes No If yes, please list their names:

- I have authority to sign on behalf of the other owners of the property **listed above in step in 4***
- I confirm that I have read the description of the activity and seen and signed the site plans attached.
- In signing this written approval, I confirm that I understand the proposal and understand that the consent authority will permit the applicant to undertake the activity (provided they have supplied the correct information, including all other written approvals required).
- I understand that I may not withdraw my written approval.

** If signing on behalf of a trust, company or other owners, please provide additional written evidence that you have signing authority.*

Full name

Signature

A signature is not required if the application is made by electronic means

5. Contact details

Name

Phone number

Email

Postal address

(or alternative method of service under section 352 of the Act)

Note to person signing written approval

- You should only sign this form if you fully understand the proposal. You should seek expert or legal advice if you need the proposal or deemed permitted boundary activity process explained to you.
- Conditional written approvals cannot be accepted, and written approvals cannot be withdrawn once provided.
- There is no obligation to sign this form, and no reasons need to be given.
- If you do not sign this form, resource consent may be required for the activity and you may have the opportunity to submit on the application.

22/5/26

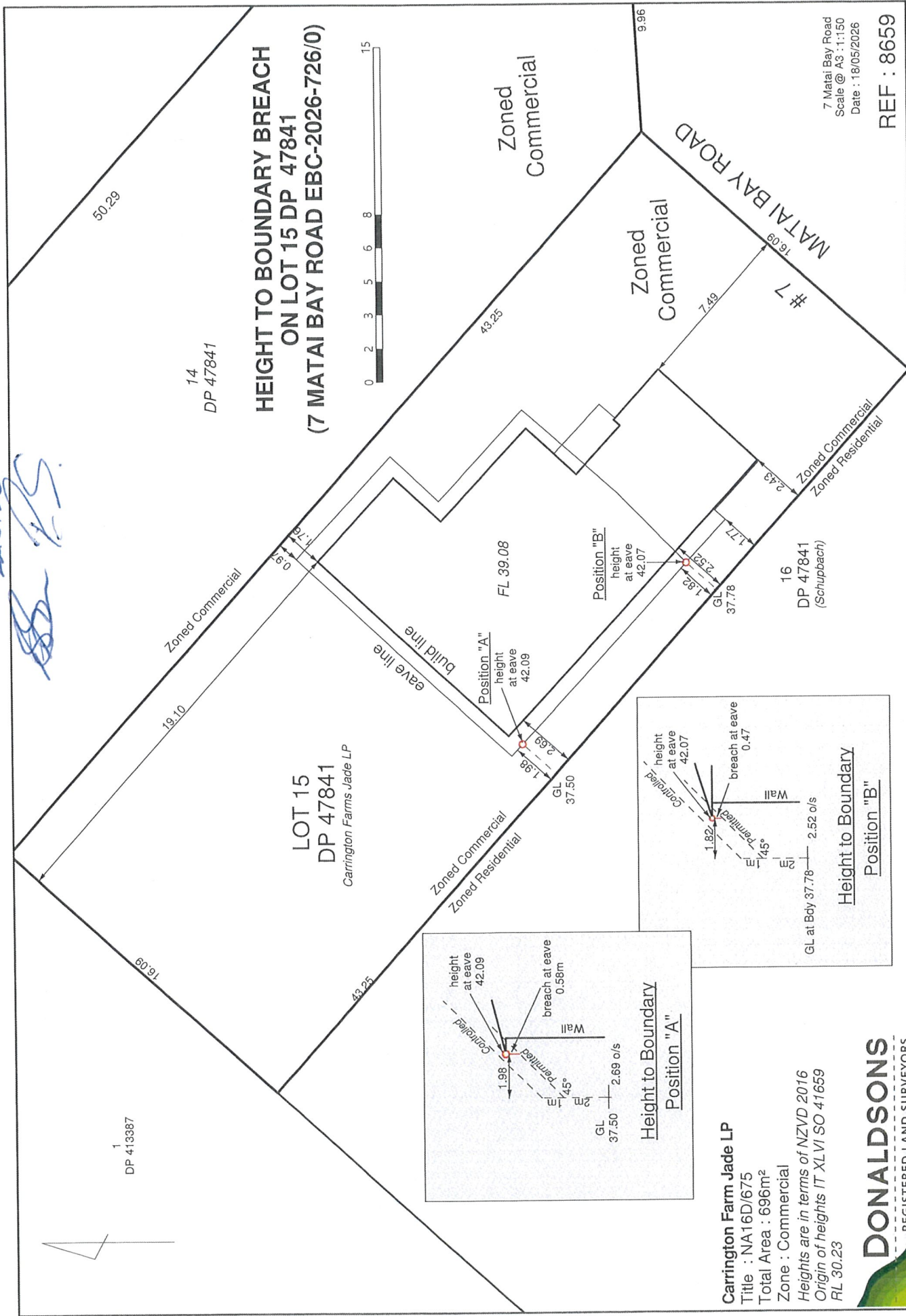

1
 DP 413387

14
 DP 47841

**HEIGHT TO BOUNDARY BREACH
 ON LOT 15 DP 47841
 (7 MATAI BAY ROAD EBC-2026-726/0)**



**LOT 15
 DP 47841
 Carrington Farms Jade LP**

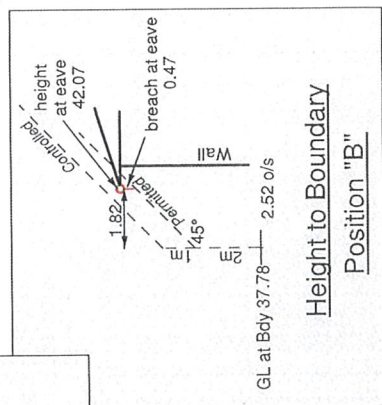
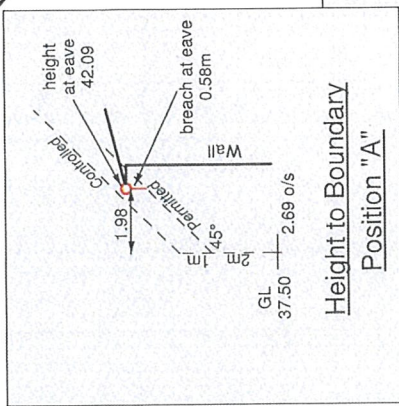

Carrington Farm Jade LP
 Title : NA16D/675
 Total Area : 696m²
 Zone : Commercial
 Heights are in terms of NZVD 2016
 Origin of heights IT XLVI SO 41659
 RL 30.23

DONALDSONS
 REGISTERED LAND SURVEYORS

7 Matai Bay Road
 Scale @ A3 : 1:150
 Date : 18/05/2026

REF : 8659



**RECORD OF TITLE
UNDER LAND TRANSFER ACT 2017
FREEHOLD
Search Copy**



R.W. Muir
Registrar-General
of Land

Identifier **NA16D/675**
Land Registration District **North Auckland**
Date Issued 24 April 1969

Prior References
NA1859/20

Estate Fee Simple
Area 696 square metres more or less
Legal Description Lot 15 Deposited Plan 47841

Registered Owners
Carrington Farms Jade LP

Interests

W. Karikari S.D.

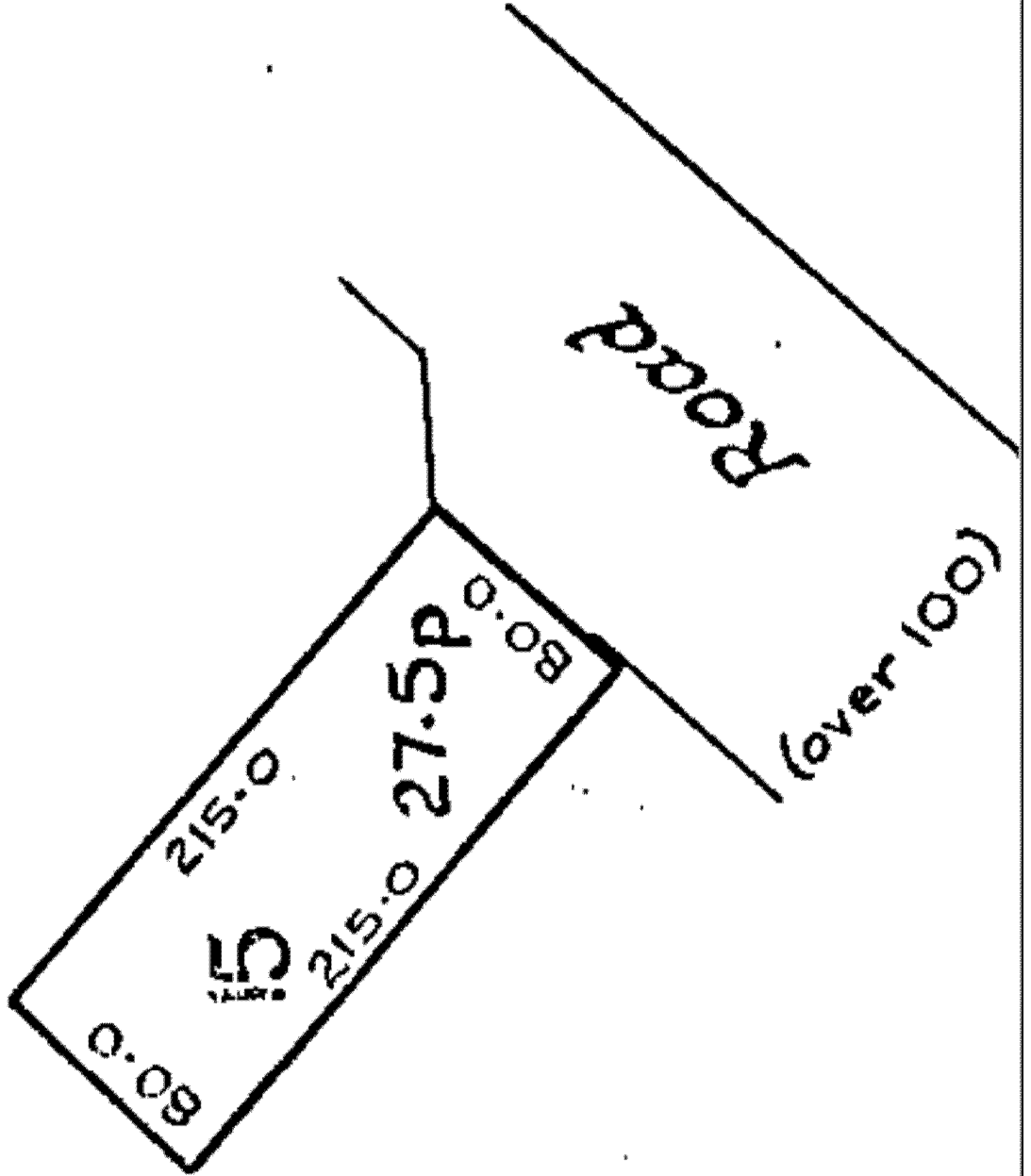



CERTIFICATION OF BUILDING POSITION

Issued by: R J Donaldson
Licensed Cadastral Surveyor

Job Ref: 8659

To: Carrington Farms Jade LP
At: 7 Matai Bay Road, Karikari
(Site Address)

Donaldsons Surveyors Ltd has been engaged by William Tan.
to provide the service of checking the position of a building on Lot 15 DP 47891.
The building was located on site as per the attached Donaldsons Surveyors site plan.
Approved Building Consent Document EBC-2026-726/0.
The site visit was carried out on 12th May 2026, and we issue this certification in the knowledge that it will be relied upon by Far North District Council for the purpose of building consent inspection works.

A handwritten signature in blue ink, appearing to read "R Donaldson", is written over a dotted horizontal line.

Bob Donaldson
(Surveyor)

Licensed Cadastral Surveyor No 500687
(Professional Qualification)

Dated: 18th May 2026

CSNZ & NZIS
(Member)

On behalf of: Donaldson's Surveyors Ltd

Address: 90 Kerikeri Road, Kerikeri



CSNZ THE CONSULTING
SURVEYORS
OF NEW ZEALAND
A DIVISION OF THE NEW ZEALAND INSTITUTE OF SURVEYORS

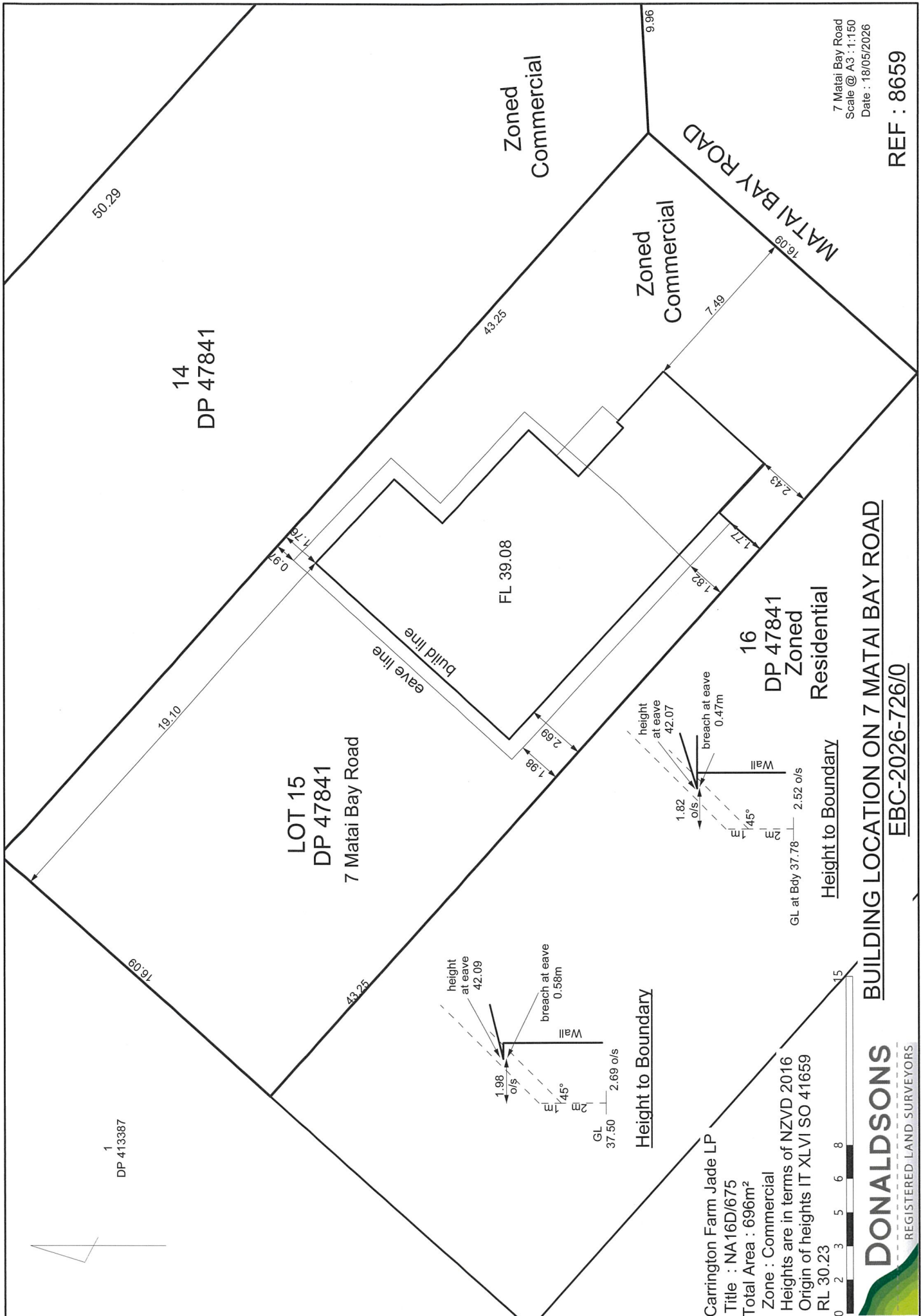

DP 413387

Carrington Farm Jade LP
 Title : NA16D/675
 Total Area : 696m²
 Zone : Commercial
 Heights are in terms of NZVD 2016
 Origin of heights IT XLVI SO 41659
 RL 30.23



DONALDSONS
 REGISTERED LAND SURVEYORS

Land / engineering Surveyors & development planners

90 Kerikeri Road, Kerikeri, Northland, New Zealand

www.donaldsons.net.nz

em: info@donaldsons.net.nz - p:09 4079182

7 Matai Bay Road
 Scale @ A3 : 1:150
 Date : 18/05/2026

REF : 8659

BUILDING LOCATION ON 7 MATAI BAY ROAD
EBC-2026-726/0